

2013



Relax and slow down...



KateBoats
HIRE FLEET



Discover the beauty of Britain's waterways at a giddy four miles per hour



Welcome to Kate Boats

Whether you are looking for a fun family holiday with a difference, or simply want

to unwind and take life at a more tranquil pace, you'll find our growing fleet of narrowboats provide a level of comfort and convenience usually associated with privately owned craft.

With Kate Boats, you can cruise the 137 miles and 166 locks of the Grand Union Canal, explore the delights of the winding Oxford Canal, or set your sights on visiting Stratford, 20 minutes by road, but an interesting 7 day round trip by canal. Set off from our working boatyard, just half a mile from the centre of the historic town of Warwick or from the picturesque banks of Stockton Top Marina, a mere twenty minute drive from Warwick.

Fuel and damage waiver inclusive prices

The price quoted is the price you pay, we include diesel and damage waiver that many other hire companies will add as extras.

The Stockton boats are available for short breaks, Monday to Friday or Friday to Monday, or a combination, allowing you flexibility in your holiday planning. The Warwick boats start on a Saturday, for a week (or two, or maybe three!). Kate Boats welcomes back many hirers year after year, and are always pleased to offer a 5% discount on the first week of any booking to our returning friends.

Genuine care and attention goes into every Kate Boats canal break. The boats are fully equipped with all the comforts of home. All the boats have TVs with DVD players, a 240 volt hairdryer, normal household sockets to plug your phone and battery chargers into, fresh water flushing toilets, central heating, and a galley equipped with fridge, gas cooker and some of the boats even have microwaves. We are part of the Enjoy England Narrowboat Grading Scheme, all boats are inspected and graded to ensure that you know what to expect when you book with us. We range from Thomas David, 2 star, great value boating, to the 5 star new boats, luxury boating at its best.

We hope you enjoy our brochure and website. If you would like to discuss your boat and holiday options we're always happy to talk to you in person. Here's hoping for pleasant cruising and kind weather throughout the season.

Nick and Cheryl Howes.

Contents

P3	Welcome
P4	Thomas David Dorothy Constance
P5	Amy Clare Madeleine Molly May Harry
P6	Florence Edith Esma Frances Isabella Peter Michael
P7	Samuel James Alexander
P8	Rebecca Richard John
P9	Rachel Martin Marie Stephen
P10	Jemima Jim Susan Patricia Helen
P11	Jenella Robert Georgina Kate Elizabeth
P14	Useful information
P15	A traveller's journal
P16	Prices

Always on hand to help

If you have any questions, would like to check availability or make a reservation, please call 01926 492 968 or email enquiries@kateboats.co.uk.

Meet the Stockton fleet

Plan your luxury cruise or short break in style.

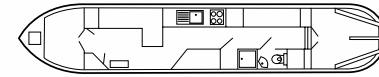

38'
footer **Sleeps 2+2**

Thomas David, our smallest boat, provides value accommodation for up to four people and is available for short breaks and longer holidays.

Enjoy your meal as you watch the world slide by from the dining and lounge area, featuring a foldaway gate-leg table and L-shaped settee which converts to a comfy double bed. He may

be tiny, but Thomas David still features a well equipped galley, ensuring that you have all you need on your trip.

In the rear cabin, Thomas David has a separate shower cubicle and flushing toilet. There are also two bunks and a vanity basin, a wardrobe, airing cupboard and locker storage.

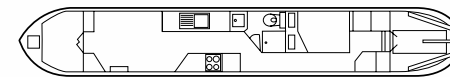

45'
footer **Sleeps 2**

Dorothy Constance is a cosy boat which has recently been refurbished, turning it into an up to date 2 berth boat, with a fixed double bed, a cross boat bathroom, with a macerator toilet.

Enjoy the new relaxing front of Dorothy Constance where you can put your feet up on recliner chairs and enjoy the full colour digital television or take in the view across the low bow.



Amy Clare

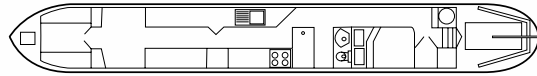

52'
footer Sleeps 2+3

Amy Clare is a cruiser stern narrowboat providing comfortable accommodation for four to five people, with a fixed double bed and three singles.

Looking out over the bow is the lounge and dining area with a desmo table and two settees, which convert to two single berths and a single bunk. We then move back into the well equipped

galley, with fridge, full sized cooker and all the facilities you need to cook whilst afloat.

The well equipped bathroom provides a bath with shower above. In the rear cabin you'll find plenty of storage space in the large wardrobe, wet locker and airing cupboard, and a permanent double berth.



Madeleine

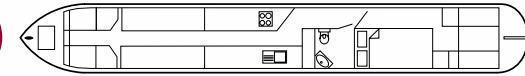

47'
footer Sleeps 2+2

New for 2012, Madeleine gives a fixed double at the rear, and two singles or a double to convert in the lounge area.

She comes fully equipped, as are all our 5 star boats, with a power shower and macerator toilet in the bathroom, and everything you might need in the galley, including a domestic size gas

cooker, a fridge with freezer compartment and a microwave.

As with all our boats, she has 'normal' 3 pin sockets for charging phones and cameras, and a TV with DVD player.

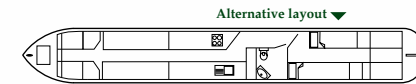

Molly May

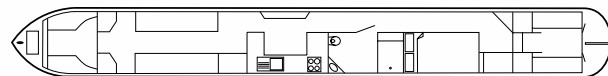

52'
footer Sleeps 2+2

Molly May is a 5 star 52 foot semi-traditional stern narrowboat, giving extremely spacious and luxurious cruising for 2 to 4 people. She has a fixed double at the rear, then a roomy bathroom with shower and macerator toilet.

The galley is fully equipped with 240 volt fridge, gas cooking and a microwave.

The lounge area gives comfortable seating during the day and at night can convert either to two singles or to a cross boat double bed.

Please note: Molly May is a pet free boat.



Harry

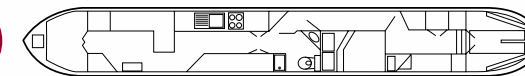

52'
footer Sleeps 4+2

Harry is designed to accommodate six people. What better way to dine than in the fore cabin, with clear views over the low bow. A foldaway gate-leg table and L-shaped settee easily converts to a double berth. This dining and lounge area perfectly sums up the versatile nature of life afloat.

The middle cabin has a permanent double bed with drawers under, and added storage space in two large wardrobes.

Also in the middle cabin is the bathroom with shower, hand wash basin and fresh water flushing toilet. In the rear cabin are two further single bunks, airing cupboard and locker.

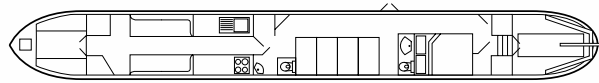

52'
footer **Sleeps 2+4**

Providing accommodation for up to six people. The front cabin gives you a comfortable seating area which easily converts to two single berths after dark.

This leads into the well equipped galley, giving you all you need to cook whilst on board.

The raised dinette in the middle cabin converts easily into a double bed; this can be left made up. The cabin also features a second TV point plus access to the first of two toilets.

A fully equipped bathroom provides a bath, shower and a second toilet. The rear cabin offers a full size double bed, a large wardrobe, airing cupboard and a useful wet locker.

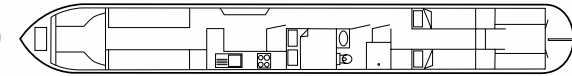

58'
footer **Sleeps 4+2**

Esma Frances is an elegant semi-traditional style boat fitted out to the very highest standard, providing luxury accommodation for up to six people. The forward lounge features a dining area with comfortable seating which converts into a double berth, or two single berths.

The U shaped galley provides easy cooking facilities. Next to this is the fully tiled bathroom, with shower cubicle, followed by a fixed double bed. And finally, the rear cabin with twin beds (which can be converted to a cross boat double), and a second TV, providing the flexibility of using this as a second day cabin.

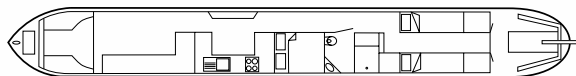

58'
footer **Sleeps 4+2**

Isabella is a 58 foot 5 star cruiser stern boat sleeping up to 6 people. The relaxing lounge area has comfortable seating for 6 people, and an L-shaped dinette converted to provide a double bed.

The fully equipped galley includes a fridge, microwave and gas cooker, along with crockery

and utensils to make cooking on board a pleasure.

She has a fixed double bed and two fixed singles at the rear, which can be converted to a cross boat double bed. Both cabins are separated by a bathroom equipped with shower and macerator toilet.

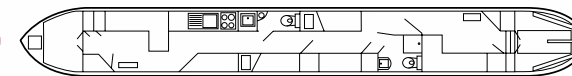

60'
footer **Sleeps 4+4**

Peter Michael can accommodate six to eight people and, uniquely, be divided into four separate cabins. The front cabin affords scenic views over the low bow, and incorporates the dining and lounge area with extensive seating, folding gate-leg table and large L-shaped settee which converts to a double berth.

A toilet and vanity basin are housed in the second cabin which also contains two bunks. Further

along, the third cabin has two bunks and two large wardrobes. There is also a side access to this cabin.

The shower room, with the second toilet and basin, separates the third and fourth cabins. In the fourth cabin is an airing cupboard, large wardrobe, table and L-shaped settee that converts to another double berth.



Samuel
James

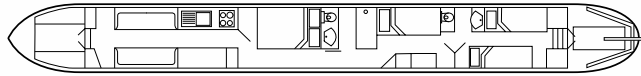

63'
footer **Sleeps up to seven**

The spacious fore cabin gives excellent views over the bow from the dining area and lounge, which has two large settees and a gate-leg table.

An excellently equipped and roomy galley means mealtimes are easily catered for with plenty of worktops and storage.

A door leads through to a separate cabin with side hatch, with a permanent double bed, large wardrobe and en-suite.

The next cabin has a single bed with a bunk above and access to the second toilet and a basin. In the rear cabin are a further two single beds with a full size bunk over one, and wardrobes, an airing cupboard and wet locker before steps leading up to the rear deck.



Alexander

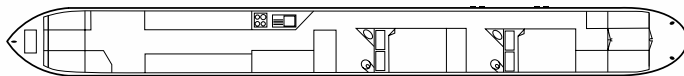

65'
footer **Sleeps 4+2**

Semi-traditional Alexander offers spacious accommodation for up to six people. Alexander features two fixed double beds and two bathrooms, plus a further convertible double bed.

The forward lounge is equipped with comfortable chairs plus a dinette, which can be converted to a double bed.

The adjacent galley has ample storage and a side hatch provides ventilation and easy access. This leads to two further cabins, each with a fixed double and en-suite shower room.

*Every day is a
journey of discovery.
There's always
something that takes
your breath away.*

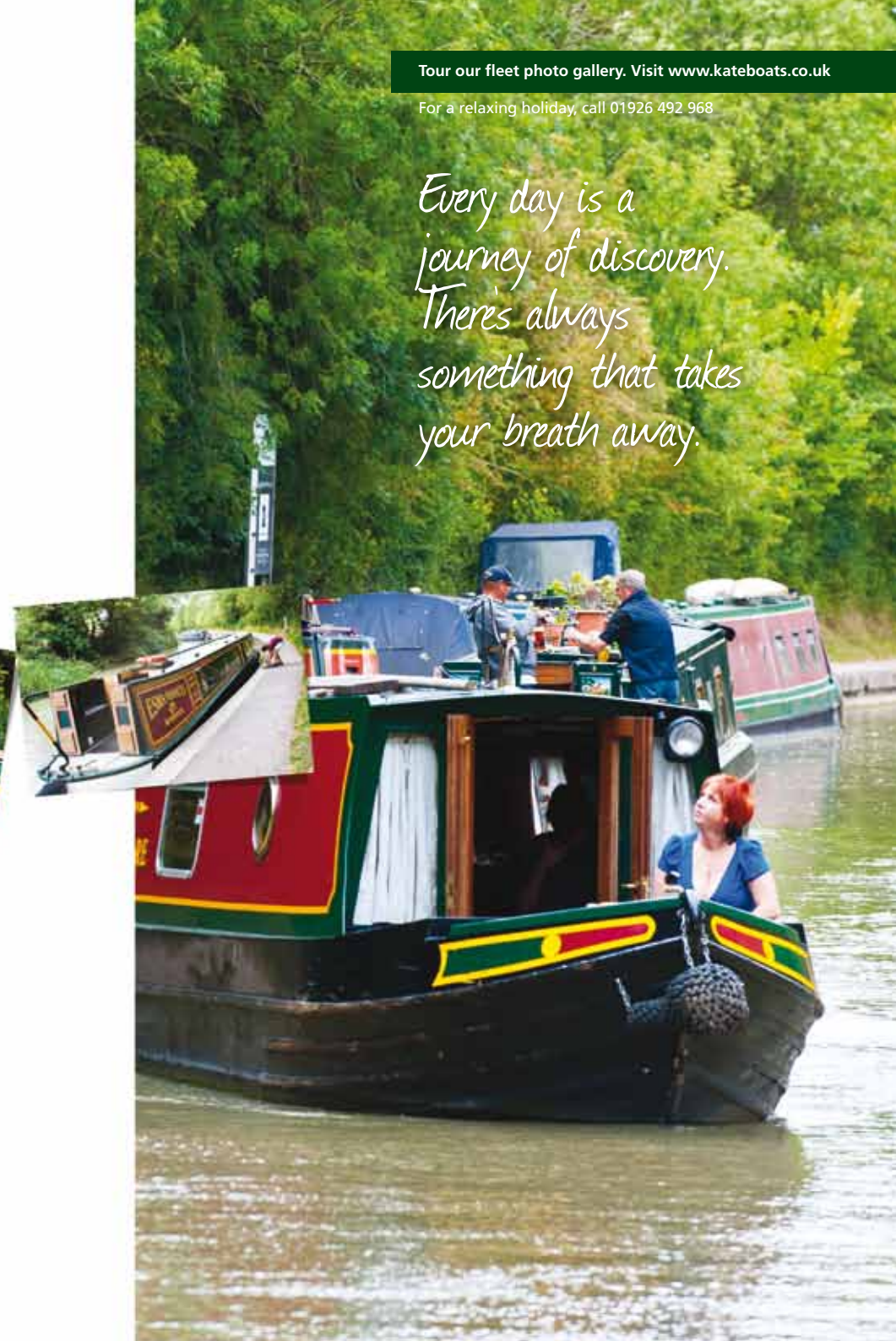

Meet the Warwick fleet

Start dreaming about that long, slow cruise.

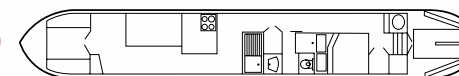
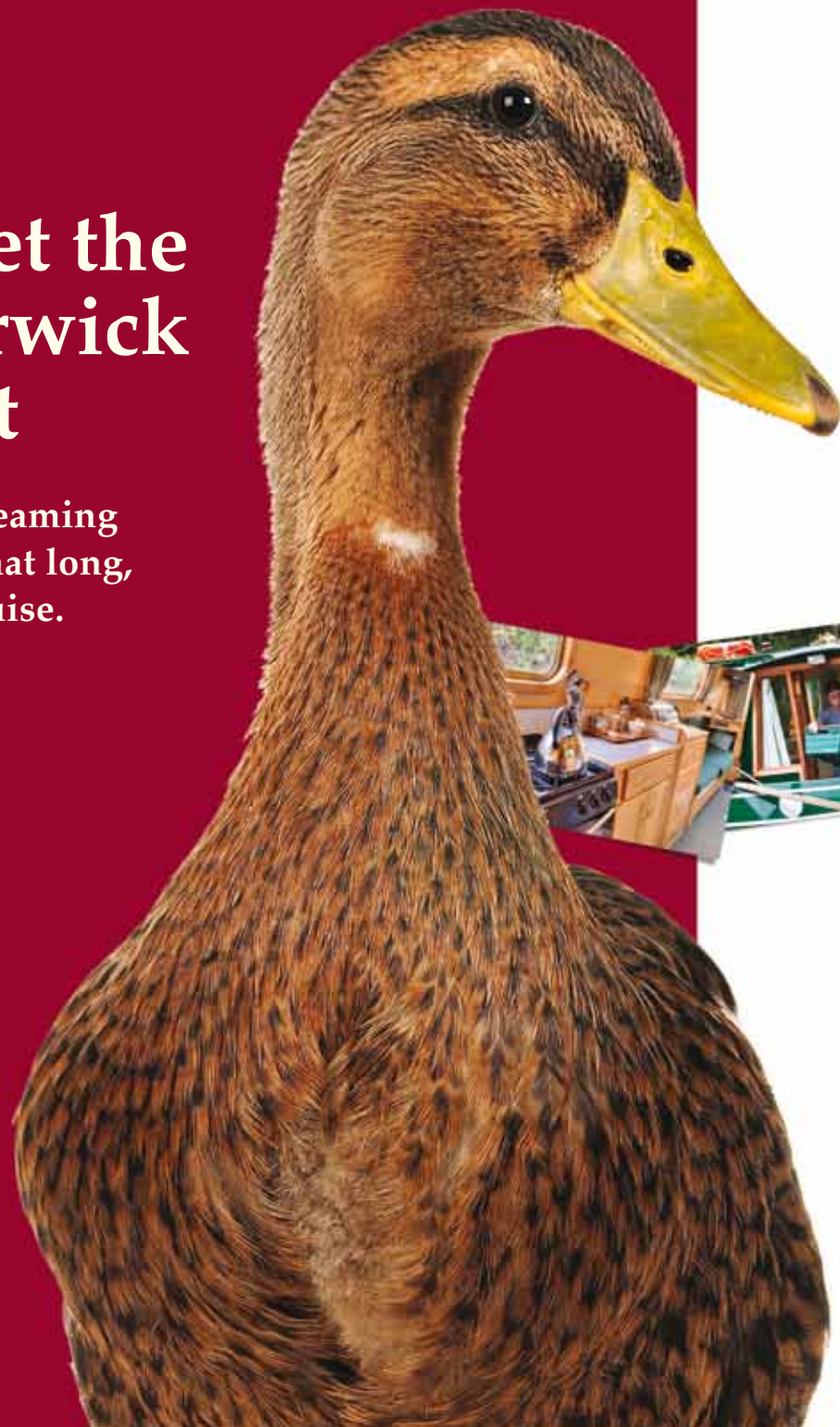

47'
footer **Sleeps 2+2**

Rebecca provides ample accommodation for up to four people.

Giving clear views over a low bow, the lounge area is located in the fore cabin. This features a comfortable sofa, which converts to a double bed if required.

An unusual touch in the fully equipped galley is provided by a breakfast bar with stools below.

Centrally, is a bathroom with fully tiled shower, toilet and hand wash basin. A permanent double bed is housed in the rear cabin, with storage space underneath. A large wardrobe and lockers provides spacious storage areas, with steps giving access to the roomy cruiser stern deck.

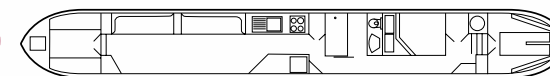

52'
footer **Sleeps 2+3**

Richard John provides spacious and comfortable accommodation for four to five people. The fore cabin is particularly spacious, with clear views over the low bow he houses a comfortable dining and lounge area with a settee that converts to a double berth, another settee giving a single berth, and a foldaway table.

The bathroom has a bath with shower over, and the rear cabin features a permanent double bed, with storage space provided under the bed and in the large wardrobe. An airing cupboard and locker provide extra room for waterproofs, windlass and mooring stakes.



Rachel

47'
footer **Sleeps 2+2**

Rachel is a luxurious semi-traditional style boat, with a fixed double at the back.

Further through the boat you pass the bathroom with power shower and macerator toilet, then on to the fully equipped galley, and the forward saloon, giving seating during the day with a

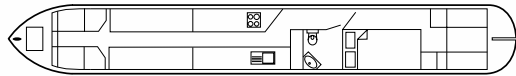

Alternative layout ▼

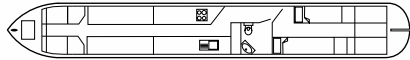

removable centre table, and converting to either two singles or a large double at night.

As with all our boats, she has 'normal' 3 pin sockets for charging phones and cameras, and a TV with DVD player.



Martin

47'
footer **Sleeps 2+2**

Martin is a comfortable, semi-traditional narrowboat with a fixed double bed in the rear cabin. Moving on down the boat you pass the luxurious bathroom, with power shower and macerator toilet.

Next is the well equipped kitchen, with full sized cooker, underbench fridge and microwave.

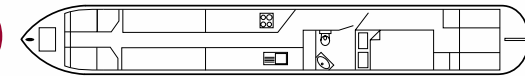

The spacious lounge area has seating that converts either to two singles or a further double.

This boat is a firm favourite with couples, spacious luxury for two, but very easy to handle.



Marie

54'
footer **Sleeps 4+1**

Marie is a semi-traditional style boat, fitted luxuriously in ash, she is light and airy; a good example of the high quality boat building that Kate Boats is renowned for.

The front lounge area has a removable dining table and foldaway chairs. The seating converts to a single bed, if required.

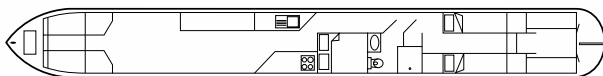

Moving on, through the fully equipped galley, we have a fixed double bed and then a bathroom with shower and toilet. In the rear cabin are two single beds, which can be converted to a cross double, and a further TV.



Stephen

58'
footer **Sleeps 4+2**

Stephen is an elegant semi-traditional style boat fitted out to the very highest standard, providing comfortable accommodation for up to six people.

The forward lounge features a dining area with comfortable seating which converts into a double berth.

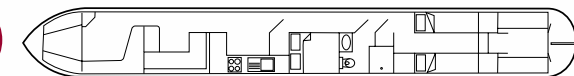

Twin beds and a second TV in the rear cabin provide the flexibility of using this as a second day cabin.

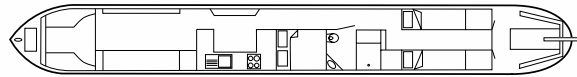

58'
footer Sleeps 4+2

Jemima is a 58 foot cruiser stern narrowboat with a spacious front lounge and flexible seating that allows for a dinette which will seat 6 for dinner, and then for night time convert either to a cross double, or two singles.

The galley is fully equipped to allow for catering on board, with a full size 4 ring gas cooker,

a 240 volt under bench fridge, and all the equipment you need to eat aboard.

The bathroom features a large shower cubicle, and an electric toilet. The rest of the accommodation consists of a fixed double bed and twin singles at the rear, which can be converted to a further double, if required.

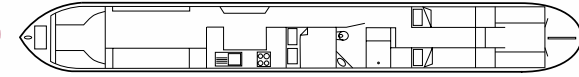
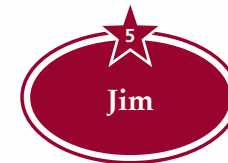

58'
footer Sleeps 4+2

Jim is a 58 foot 5 star semi-traditional narrowboat sleeping up to 6 people. The lounge area has comfy seating for 6 people and converts to provide either 2 singles or a cross boat double.

The galley is fully equipped with a fridge, microwave and gas cooker, along with all crockery and utensils to make cooking on board easy.

He has a fixed double bed and two fixed singles at the rear, which can be converted to a cross boat double bed. These two cabins are separated with a bathroom equipped with a shower and macerator toilet.

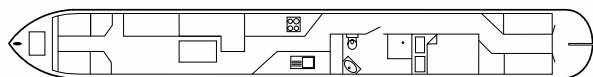

58'
footer Sleeps 2+3

Susan is a luxury narrowboat with cruiser stern providing access down to the back cabin, which houses a fixed double berth, and a child's bunk, which can be made up adjacent. There is also the first of two TVs.

Moving on forward, you go past the superb tiled bathroom with macerator toilet, on past

the fully equipped galley, and into the large lounge containing a dinette, which can convert to another double and further seating with the second TV and DVD player.

Please note: Susan is a pet free boat.

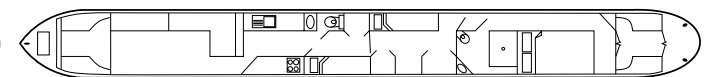

65'
footer Sleeps 6+2

Sleeping up to 8 people, Patricia Helen is a semi-traditional narrowboat with a 5 foot well deck providing an outside seating area.

Once inside there is a large lounge, and dinette which converts to a double bed, with a spacious galley beyond. The galley holds a four ring gas hob cooker, stainless steel sink, and under bench fridge with freezer compartment. Further down are two cabins with bunks, one also having a

toilet and washbasin. On past the large side hatch and spacious wardrobe is a bathroom, with second toilet and shower. Behind this is a fixed double bed, and a second TV.

Steps lead up to the semi-traditional stern area.



Jenella

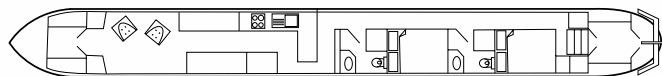

65'
footer **Sleeps 4+3**

Jenella has a semi-traditional stern and offers spacious accommodation for up to seven people. The forward cabin houses three people in convertible beds, and there are two other cabins each with shower room and double bed.

The forward lounge is equipped with comfortable chairs plus a dining area with removable table. The flexible seating converts to either two single beds or a double, and an additional single bunk is available above, if required.

The adjacent galley has ample storage space and a side hatch which provides ventilation and easy access. The middle cabin includes a shower room with shower and toilet. There is a permanent double bed with wardrobe, under bed drawers and cupboards above. The aft cabin is similarly equipped with double bed and en-suite shower room and toilet.



Robert

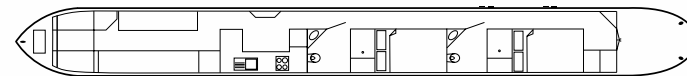

65'
footer **Sleeps 4+2**

New in 2011, Robert provides luxury cruising for up to 6 people, with two fixed double beds, two bathrooms and an additional double, or two singles in the lounge area.

The outside front deck area is extended to provide additional outside seating. The forward lounge consists of comfortable flexible seating, with a removable table to give a large dining area which converts either to a large cross

boat double bed, or two singles. The galley is fully equipped with a microwave, gas cooking and ample storage, and a side hatch provides ventilation and easy access.

The middle cabin consists of a permanent double bed, and an en-suite shower room with toilet. The aft cabin is similarly equipped with en-suite and toilet, plus a further colour TV.



Georgina

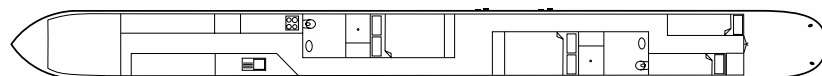

New 13 70'
footer **Sleeps up to 8**

The new flag ship for the fleet is a 5 star boat, sleeping up to 8, with two bathrooms.

The spacious lounge has flexible seating, converting either to 2 singles or a double. As with all the fleet the kitchen is fully equipped with a gas cooker and underbench fridge with freezer compartment. She will also have a microwave.

Further down the boat is a bathroom with macerator toilet, two further fixed doubles, another bathroom, and then a rear cabin with a fixed double that splits to make two fixed singles.

The boat has cruiser stern giving a spacious rear deck.

Alternative layout ▼

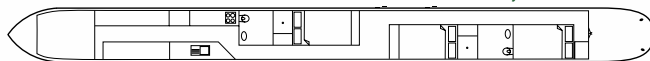

Kate Elizabeth

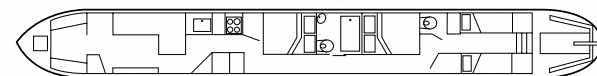

65'
footer **Sleeps up to seven**

Kate Elizabeth provides comfortable accommodation for up to seven people. There are two permanent double beds, two single beds and the facility for an additional bunk, if required.

She has a comfortable lounge area, with a table for dining, and a settee that can convert to a further double bed.

Passing through the well equipped galley you reach the first of the fixed double beds. Further on, the bathroom, containing a bath with shower over, is opposite an opening side hatch. Then we come to the second fixed double and, finally, past the second toilet to the rear cabin containing two single beds, one of which has a bunk over.

The peace and tranquility of a long, slow cruise

One week cruise

Warwickshire Ring: a comfortable cruise taking in Napton, pretty Braunston, Hawkesbury, Fazeley and the North Stratford Canal to Kingswood, returning through the dramatic flight of locks at Hatton.

Approx 54 hrs, 94 locks.

Stratford: take in Shakespeare's historic birthplace of Stratford-on-Avon, the 21 locks of Hatton flight and then Kingswood junction to the Southern Stratford Canal. Moor in Stratford near the beautiful Memorial Theatre.

Approx 37 hrs from Warwick; 50 hrs from Stockton Top, 110 locks.

Ashby Canal: a leisurely cruise through Braunston, Hillmorton and Marston to visit the historic site of the Battle of Bosworth Field.

Approx 40 hrs from Warwick, 28 hrs from Stockton Top.

Stoke Bruerne: cruise through Blisworth Tunnel to the Waterways Museum on the Grand Union Canal through Braunston, Norton junction and Weedon.

Approx 38 hrs from Warwick, 72 locks.

Oxford Canal: a pleasant cruise to Banbury through Napton and Cropredy. Possible midweek breaks from Stockton Top Marina.

Approx 38 hrs from Warwick.

Map for illustrative purposes only

For more detailed route information visit www.kateboats.co.uk/maps

Two week cruise

Leicester Circuit: this is a varied and interesting cruise taking in Foxton, Sawley and a particularly pleasant stretch on the Trent and Mersey, Fazeley junction, Hawkesbury, Rugby and the Grand Union Canal.

Approx 86 hours.

Oxford: a leisurely two way cruise down the ever popular Oxford Canal.

Approx 61 hrs.

Avon Ring: this cruise is a pleasant mix which takes in breathtaking countryside and some of the most historically interesting waterways in the country.

The route features sections of the rivers Avon and Severn, the Stratford, Worcester and Birmingham canals and the spectacular flight of locks at Hatton. Some extra tolls are applicable to this route.

Approx: 68 hrs.

Three week cruise

Thames Ring: your trip sees you travel along the Thames to Oxford, returning to Warwick along the Grand Union Canal.



The most relaxing short breaks always start at Stockton Top Marina

Short breaks

Short breaks are available Monday-Friday and Friday-Monday, giving you the perfect opportunity to test the water.

Warwick and Leamington: a pleasant cruise through quiet countryside, reaching the Stockton flight on the first afternoon and recovering with a drink at one of the pubs in Long Itchington.

On Saturday, a relaxing cruise to Leamington and Warwick, leaving Sunday free to relax on the return journey.

Braunston: turn right out of the Marina, eastwards on the Grand Union Canal. A steady cruise takes you towards Braunston tunnel. And then Sunday, return, realising that everything looks different going the other way.

Fenny Compton: again, right from the Marina, turning right at Napton junction on to the winding, contour driven South Oxford Canal. A gentle trip takes you to Fenny Compton, and a winding hole that allows you to turn and wend your way slowly home.

Map for illustrative purposes only

For more detailed route information visit www.kateboats.co.uk/maps

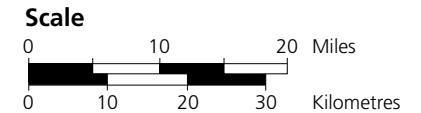

Useful information

What does the hire fee cover?

Our boats are hired complete with all equipment and a full inventory of domestic items is on board. Bedding is provided.

When you take over your boat it will have been refuelled, the water tank filled and new gas bottles connected. Gas and diesel are included in the hire fee and your boat carries sufficient diesel fuel for two weeks' normal cruising.

What are the boats equipped with?

Our boats are designed to provide you with a home from home, to allow you to enjoy your holiday to the full. All of the boats have a fully equipped galley. There is a gas cooker, grill and four burner hob and an under worktop 240 volt fridge with a small freezer compartment.

The boats are all centrally heated, some with gas boilers, some with diesel boilers. The boiler also provides plentiful hot water. Bathrooms are equipped with freshwater flush toilets, good showers, and some also have baths. Each boat has an airing cupboard.

240 volt electricity is available with standard plugs, suitable for charging mobile phones and other electrical devices. A hairdryer is available on each boat.

Television and DVD player

Your boat is equipped with a colour TV/DVD player and Radio/CD player. By their nature, canals tend to be low lying, and television reception may not be as good as you have at home.

Arrival and departure times

Your craft should be returned by 9.00am on the last day of hire and vacated by 9.30am. However, if you want to make the most of your last day, Warwick Castle is only a few minutes drive away, and is certainly worth a visit.

Craft are normally available from 2pm. Please let us know if you expect to arrive later than 3pm. We have no facilities for late arrivals.

Free car park

We do have our own private car parks but space is limited and restricts us to two cars per boat, parked free at your own risk. We will require you to leave your keys with us while you are aboard.

Books and maps

Waterways guides are essential for your cruise as these show the facilities you will need. We have a wide range of guides and maps which are available in our shop. We would be pleased to send your requirements to you in advance of your holiday.

Before you come

We suggest you watch the Boaters Guide DVD, which is available online at the Waterscape site (links can be found from our website). It provides useful information if you haven't done this before, and a helpful reminder for those that have.

Taking over the boat

Before you start your cruise we will give you full instruction covering all aspects of canal cruising and locking. If you have not handled a narrow boat before we will accompany you through a lock. A manual provides valuable information and reminders on safe navigation along with the Boaters Guide DVD and handbook.

A list of useful telephone numbers and canal information is also included.

Licences

Your boat is licenced for all BW waterways. Certain other waterways require special licences which must be obtained before or during the trip. These include the Upper and Lower Avon navigations, river Nene and river Thames. Payment of these licences is the responsibility of the hirer.

Buoyancy aids

We provide buoyancy aids free of charge for those requiring them. We suggest that children wear them at all times, especially when near locks.

Pump out toilets

All our craft are fitted with pump out type toilets. They have a fresh water flushing action similar to that of a domestic toilet. They are unlikely to need emptying during your holiday.

Water

All boats carry a good supply of water but it is advisable to top up daily. It is wise to plan your water stops. The location of water points are shown in the cruising guides.

Pets

We are pleased to accept pets on board, but we do ask co-operation in keeping them off bedding and seating. A charge of £25 per pet is made. Two boats, Molly May and Susan are strictly pet free to cater for allergy sufferers.

Clothing

We suggest casual clothing, wet weather gear and sensible footwear such as trainers. For returning to the boat after dark a torch can be very useful.

Insurance

We recommend that you take out personal travel insurance to cover your travel arrangements in case of emergency.

Further information

If you have any questions, would like to check availability or wish to make a reservation, please call 01926 492 968 or email enquiries@kateboats.co.uk

For a photo gallery tour of our fleet, please visit www.kateboats.co.uk

A traveller's journal

Day #1. Our first time on a narrowboat. A great welcome. An hour's instruction and we set off down the canal, with John supervising. The boat seems very long, but by the time we got to Radford Bottom Lock we felt quite experienced. John met us at the lock and showed us how it worked. It was easy, really. Moored for the first night at a lovely piece of countryside. Enjoyed cooking on the boat. Weather clear and warm.

Day #2. Early departure, galley staff providing bacon sandwiches to the crew. Made it to the top of the Stockton Locks. Having met up with another boat, with a very experienced crew, we paired up through the locks and gained lots of tips. We decided to stop just beyond Kate's Stockton base at the pub there for an evening meal. Kids have enjoyed spotting wildlife and generally being busy doing nothing!

Day #3. Down the South Oxford canal today, different locks: these are narrow ones, so no pairing up. Picked up fresh bread and milk at the little shop at Napton. The countryside is very pretty, winding round the windmill at Napton. Stopped at the pub for lunch. Got to Fenny Compton for the night. Cooked on the boat again. TV reception is great here. We are all really relaxed and sleeping well. Weather fine and warm.

Day #4. On to Banbury, today. We have moored in the middle of town. They have redeveloped the canal side very nicely here, and we popped into the supermarket to top up with supplies.

Day #5. On our way back! Boo! We turned in Banbury, which was exciting. Luckily no one was watching, because although we had had the theory explained it took a bit of working out, but we managed. Moored tonight at Fenny Compton, and ate in the pub. When we got back to the boat we realised that we hadn't moored the boat up very well and one of the mooring pins came out, but the next boat along had rescued us, and retied it. Weather overcast, little rain midday.

Day #6. Back as far as Stockton Top Marina, today. Love the way you actually get chatting to people, mainly at locks, but just on the tow path as well. Everyone you go past waves. Weather fine.

Day #7. Back to Warwick! Kids have got the locks off to a fine art now. We are all working like a team. We are moored at the boatyard to make for easy unloading in the morning. We are intending to spend the day at Warwick Castle tomorrow as a final treat, and then back home. Weather cloudy, but still warm.

In summary: glad we arrived in good time on the first day, so much information to take in! Should have brought a torch, would have been useful a couple of times. We have had a lovely time, certainly will try it again. Maybe Stratford next time.



Short break prices

Stockton: Friday & Monday departures

	Thomas David	Dorothy Constance	Amy Clare	Madeleine	Molly May	Florence Edith	Harry	Esma Frances	Isabella	Peter Michael	Samuel James	Alexander
	2/4 berth	2 berth	2/5 berth	2/4 berth	2/4 berth	2/6 berth	4/6 berth	4/6 berth	4/6 berth	4/8 berth	7 berth	4/6 berth
01 Mar	235	275	320	370	370	360	360	415	415	360	425	440
08 Mar	295	345	395	465	465	455	455	515	515	455	530	545
15 Mar	295	345	395	465	465	455	455	515	515	455	530	545
22 Mar	390	465	530	620	620	605	605	685	685	605	710	730
29 Mar	430	510	585	685	685	665	665	755	755	665	780	800
05 Apr	390	465	530	620	620	605	605	685	685	605	710	730
12 Apr	330	395	450	525	525	515	515	585	585	515	605	615
19 Apr	330	395	450	525	525	515	515	585	585	515	605	615
26 Apr	330	395	450	525	525	515	515	585	585	515	605	615
03 May	355	415	475	560	560	545	545	615	615	545	640	655
10 May	355	415	475	560	560	545	545	615	615	545	640	655
17 May	390	465	530	620	620	605	605	685	685	605	710	730
24 May	585	695	795	930	930	905	905	1030	1030	905	1070	1095
31 May	430	510	585	685	685	665	665	755	755	665	780	800
07 Jun	430	510	585	685	685	665	665	755	755	665	780	800
14 Jun	450	530	610	715	715	695	695	790	790	695	820	840
21 Jun	450	530	610	715	715	695	695	790	790	695	820	840
28 Jun	450	530	610	715	715	695	695	790	790	695	820	840
05 Jul	470	555	635	745	745	725	725	825	825	725	855	875
12 Jul	470	555	635	745	745	725	725	825	825	725	855	875
19 Jul	585	695	795	930	930	905	905	1030	1030	905	1070	1095
26 Jul	585	695	795	930	930	905	905	1030	1030	905	1070	1095
02 Aug	585	695	795	930	930	905	905	1030	1030	905	1070	1095
09 Aug	585	695	795	930	930	905	905	1030	1030	905	1070	1095
16 Aug	585	695	795	930	930	905	905	1030	1030	905	1070	1095
23 Aug	505	600	685	805	805	790	790	890	890	790	925	945
30 Aug	450	530	610	715	715	695	695	790	790	695	820	840
06 Sep	370	440	505	590	590	575	575	650	650	575	675	690
13 Sep	330	395	450	525	525	515	515	585	585	515	605	615
20 Sep	330	395	450	525	525	515	515	585	585	515	605	615
27 Sep	310	370	420	500	500	485	485	550	550	485	570	585
04 Oct	310	370	420	500	500	485	485	550	550	485	570	585
11 Oct	310	370	420	500	500	485	485	550	550	485	570	585
18 Oct	310	370	420	500	500	485	485	550	550	485	570	585
25 Oct	330	395	450	525	525	515	515	585	585	515	605	615
Winter	235	275	320	370	370	360	360	415	415	360	425	440

Full terms and conditions can be found at www.kateboats.co.uk

All prices include VAT at 20%. Fuel, Gas, BWB licence charges, bedding and car parking. We reserve the right to charge a fuel surcharge. A 10% discount is allowed on second week and a 20% discount is allowed on a third week. Longer periods by arrangement. We will hold telephone reservations for 7 days.

Put yourself in the picture

Call 01926 492 968, or visit www.kateboats.co.uk and start the adventure today.

